



# C-Band (INSAT) Receive Reject Filter

## Model 18323

This transmit filter provides deep rejection of the receive band with minimal effect on the transmit band.

- *Ideal for INSAT and other Region-Specific Transmit Applications*
- *Alternate Flange Configurations are Available Upon Request*

### Specifications:

Passband:	6.725 - 7.025 GHz
Insertion Loss:	0.10 dB Approx
VSWR:	1.22:1 Max
Reject Bands:	4.5 - 4.8 GHz
Rejection:	80 dB Typ
Flanges:	CPR137/CPR137G
Dimensions:	5.00" x 2.69" x 1.94" (127mm x 68mm x 49mm)
Finish:	White Lacquer

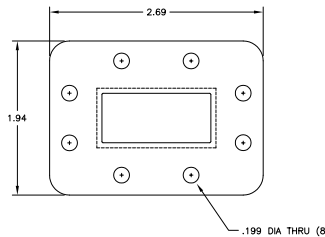

**MICROWAVE FILTER CO., INC.**  
6743 KINNE STREET, E. SYRACUSE, NY 13057  
E-Mail: [mfcsales@microwavefilter.com](mailto:mfcsales@microwavefilter.com)

800-448-1666 • 315-438-4700  
Web: [www.microwavefilter.com](http://www.microwavefilter.com)