



C-Band Transmit Reject Filter

12086 Series

The series 12086 is a family of transmit rejection filters specifically addressing the SATCOM (C-band) market. The device is installed between the antenna and the LNB in the receive segment of satellite earth terminals. It is also used in C-band transceiver applications to isolate up-link and down-link signals. The unit offers extremely low loss, typically less than 0.04 dB on receive signals while providing a high degree of transmit rejection ranging from 50 to 80 dB, depending upon the model. All units come standard with WR-229 grooved flanges, with alternate configurations available upon request.

Series 12086

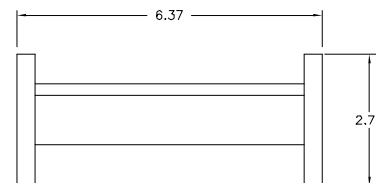
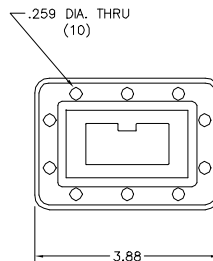
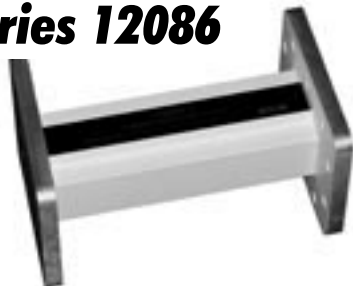

Specifications:

Model	12086-1	12086XR-1	12086-2	12086XR-2	12086-3	12086XR-3
Waveguide Size:	WR-229	WR-229	WR-229	WR-229	WR-229	WR-229
Frequency (GHz):	3.7 - 4.2	3.7 - 4.2	3.625 - 4.2	3.625 - 4.2	3.4 - 4.2	3.4 - 4.2
Insertion Loss:	0.04 dB (Max)	0.04 dB (Max)	0.04 dB (Max)	0.04 dB (Max)	0.10 dB (Typ)	0.10 dB (Typ)
VSWR (Max):	1.15:1	1.25:1	1.15:1	1.25:1	1.25:1	1.25:1
Reject (GHz):	5.925 - 6.425	5.925 - 6.425	5.850 - 6.425	5.850 - 6.425	5.825 - 6.725	5.825 - 6.725
Attenuation (Typ):	50 dB	80 dB	70 dB	80 dB	70 dB	80 dB

MICROWAVE FILTER CO., INC.
6743 KINNE STREET, E. SYRACUSE, NY 13057
E-Mail: mfcsales@microwavefilter.com

800-448-1666 • 315-438-4700
Web: www.microwavefilter.com